

NOTES: UNLESS OTHERWISE SPECIFIED:

© COPYRIGHT 2014 TEXAS INSTRUMENTS UNPUBLISHED, ALL RIGHTS RESERVED

REVISIONS			
REV	DESCRIPTION	DATE	BY
A	INITIAL RELEASE	04/04/2017	SS
B	UPDATED FOR REVISED HEATSINK	5/16/2017	SS

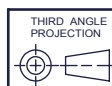
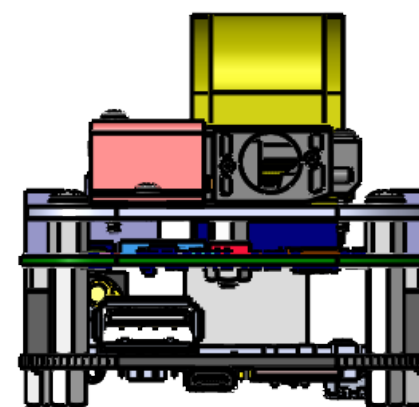
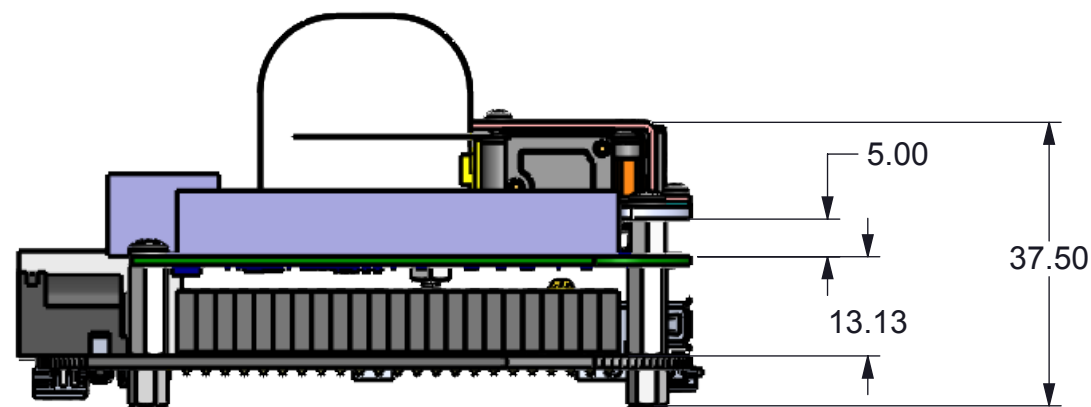
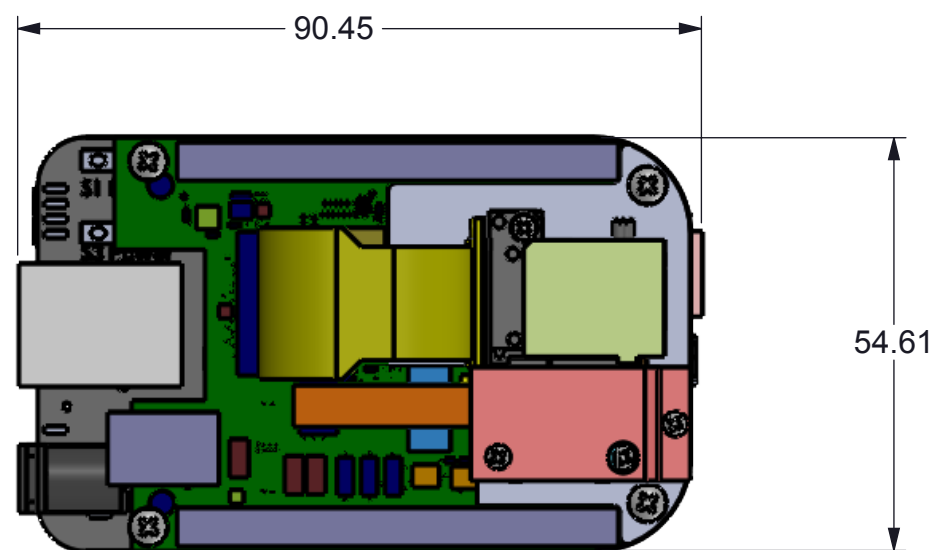

APPLICATION	USED ON	NEXT ASSY

UNLESS OTHERWISE SPECIFIED

- DIMENSIONS ARE IN MILLIMETERS
- TOLERANCES: ANGLES ±1°
2 PLACE DECIMALS ±0.25
1 PLACE DECIMALS ±0.50
- DIMENSIONAL LIMITS APPLY BEFORE PROCESSES
- INTERPRET DIMENSIONS IN ACCORDANCE WITH ASME Y14.5M-1994
- REMOVE ALL BURRS AND SHARP EDGES
- PARENTHETICAL INFO FOR REF ONLY

DWN STEVE SMITH
Engr
CQE/QA
CM
Apprvd

DATE 4/4/2017

TEXAS INSTRUMENTS

P2NHD DPP2607 EVM KIT

SCALE 1:1

SHEET 1 OF 2

SIZE B	DWG NO P2NHD DPP2607 TOP ASM	REV B
--------	------------------------------	-------

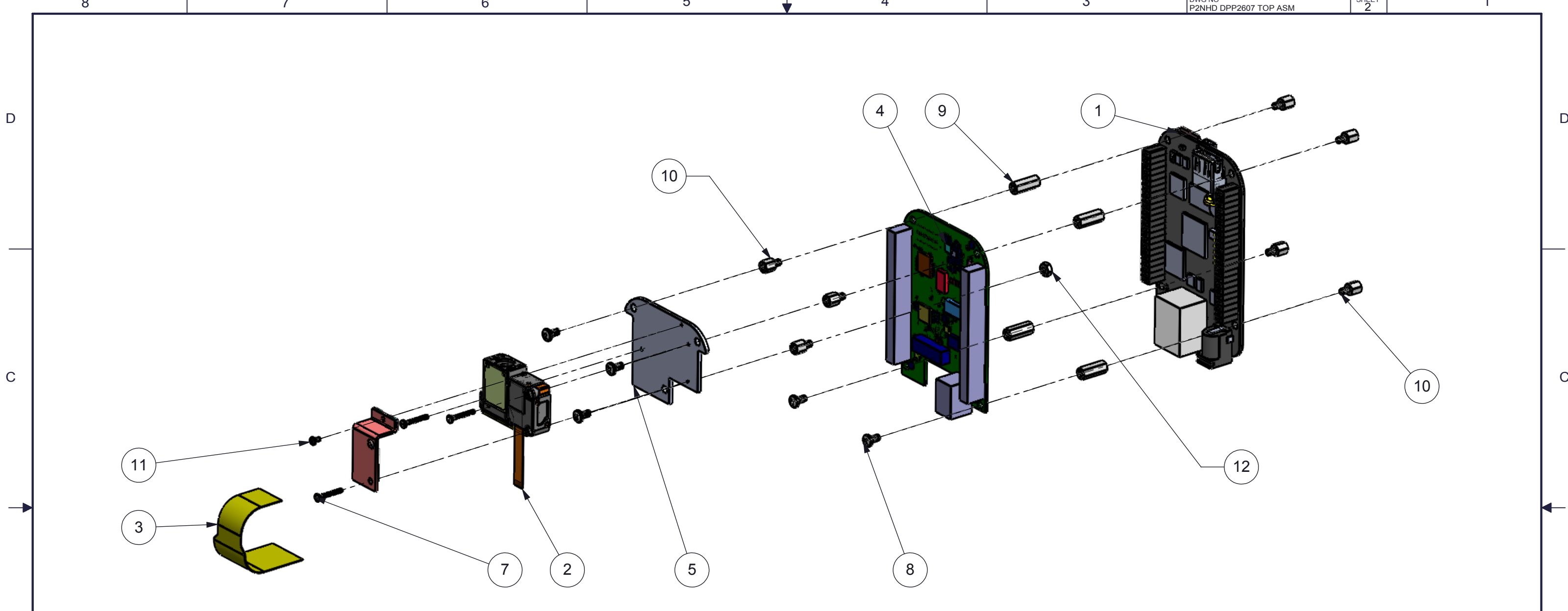

ITEM NO.	PART NUMBER	DESCRIPTION	QTY.
1	BEAGLEBONE_BLACK		1
2	fla2_asm_new_51p_SOIC_140221		1
3	LE401G001		1
4	2515210_reva		1
5	P2NHD ENGINE MOUNT	ENGINE MOUNT	1
6	P2NHD HEATSINK	HEATSINK ASSEMBLY	1
7	507701	M1.6 X 12MM PAN HEAD SCREW (FASTENER SUPERSTORE)	3
8	502355	M2.5 X 5MM LONG PHS	5
9	801744	M2.5 X 12MM LONG F-F STANDOFF (MCMaster-CARR)	4
10	801121	M1.6 X 8MM LONG SHCS (MCMaster-CARR)	7
11	507644	M1.6 X 3MM LONG PAN HEAD SCREW (FASTENER SUPERSTORE)	1
12	91828A113	M2.5 NUT (MCMaster-CARR)	1

NOTES: UNLESS OTHERWISE SPECIFIED:

1. MATERIAL: 1MM THICK ALUMINUM SHEET

© COPYRIGHT 2016 TEXAS INSTRUMENTS
UNPUBLISHED, ALL RIGHTS RESERVED

REVISIONS			
REV	DESCRIPTION	DATE	BY
A	INITIAL RELEASE	09-13-2016	SS
B	REMOVED BOTTOM BEND	4/4/2017	SS
C	ADDED Ø 4.00 AND Ø 2.50 HOLES	5/16/2017	SS

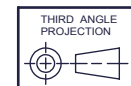
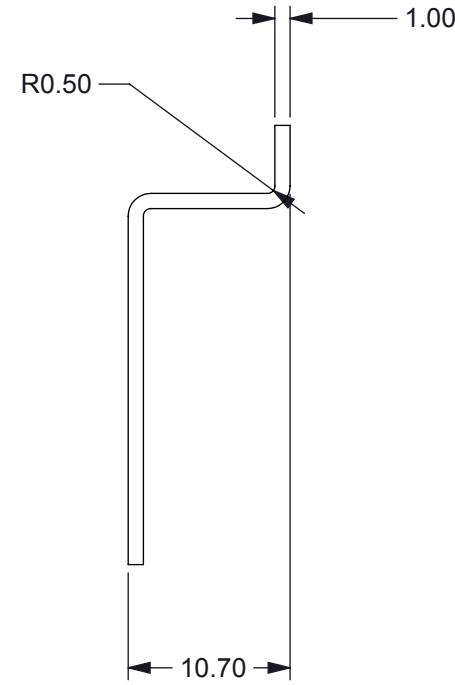
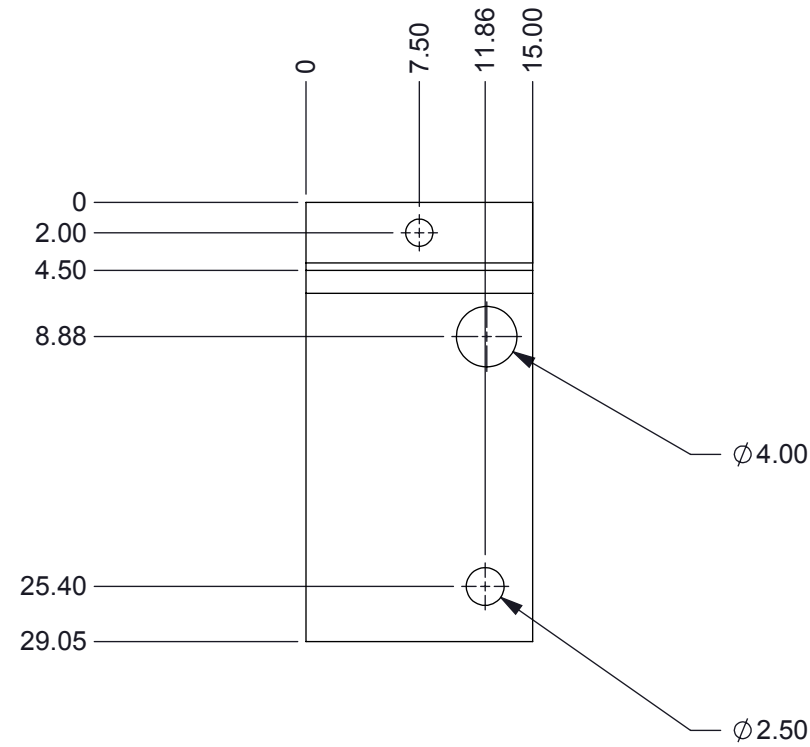

THIRD ANGLE PROJECTION	
NEXT ASSY	USED ON
APPLICATION	

UNLESS OTHERWISE SPECIFIED

- DIMENSIONS ARE IN MILLIMETERS
- TOLERANCES: ANGLES ±1°
2 PLACE DECIMALS ±0.25
1 PLACE DECIMALS ±0.50
- DIMENSIONAL LIMITS APPLY BEFORE PROCESSES
- INTERPRET DIMENSIONS IN ACCORDANCE WITH ASME Y14.5M-1994
- REMOVE ALL BURRS AND SHARP EDGES
- PARENTHETICAL INFO FOR REF ONLY

DWN STEVE SMITH Engr	DATE 9/13/2016
CQE/QA	
CM	
Apprvd	

TEXAS INSTRUMENTS

HEATSINK

SIZE B	DWG NO P2NHD LED HEATSINK	REV C
SCALE 2:1		SHEET 1 OF 1

NOTES: UNLESS OTHERWISE SPECIFIED:

1. MATERIAL: .06" THICK ALUMINUM

© COPYRIGHT 2016 TEXAS INSTRUMENTS
UNPUBLISHED, ALL RIGHTS RESERVED

REVISIONS			
REV	DESCRIPTION	DATE	BY
A	INITIAL RELEASE	09-13-2016	SS
B	UPDATED HOLE CALLOUTS	10/28/2016	SS
C	ADDED CUT, REDUCED HOLES TO 4X	4/4/2017	SS

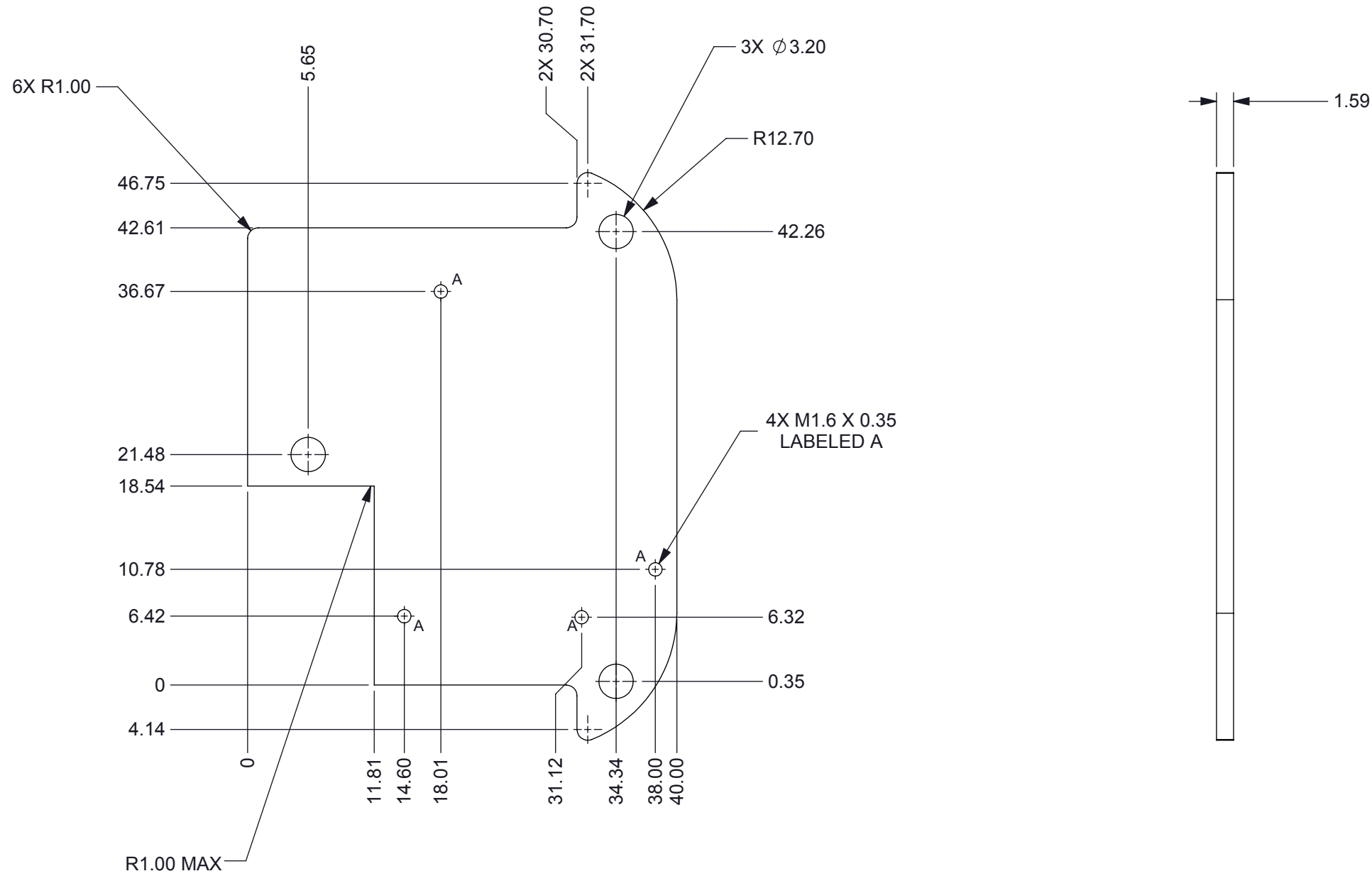

D

D

C

C

B

B

A

A

<p>UNLESS OTHERWISE SPECIFIED</p> <ul style="list-style-type: none"> DIMENSIONS ARE IN MILLIMETERS TOLERANCES: ANGLES ±1° 2 PLACE DECIMALS ±0.25 1 PLACE DECIMALS ±0.50 DIMENSIONAL LIMITS APPLY BEFORE PROCESSES INTERPRET DIMENSIONS IN ACCORDANCE WITH ASME Y14.5M-1994 REMOVE ALL BURRS AND SHARP EDGES PARENTHETICAL INFO FOR REF ONLY 		<p>DWN STEVE SMITH</p> <p>Engr</p> <p>CQE/QA</p> <p>CM</p> <p>Apprvd</p>	<p>DATE 9/13/2016</p>	<p>TEXAS INSTRUMENTS</p> <p>ENGINE MOUNT</p>
<p>THIRD ANGLE PROJECTION</p>	<p>NEXT ASSY</p> <p>USED ON</p> <p>APPLICATION</p>	<p>SIZE B</p> <p>SCALE 2:1</p>	<p>DWG NO P2NHD ENGINE MOUNT</p>	<p>REV C</p> <p>SHEET 1 OF 1</p>

NOTES: UNLESS OTHERWISE SPECIFIED:

© COPYRIGHT 2016 TEXAS INSTRUMENTS
UNPUBLISHED, ALL RIGHTS RESERVED

REVISIONS			
REV	DESCRIPTION	DATE	BY
A	INITIAL RELEASE	09-13-2016	SS
B	UPDATED PER ITEM 1 REV	4/4/2017	SS

D

D

C

C

B

B

A

A

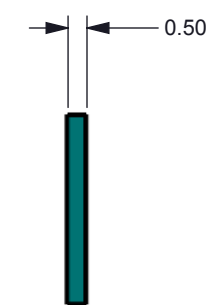
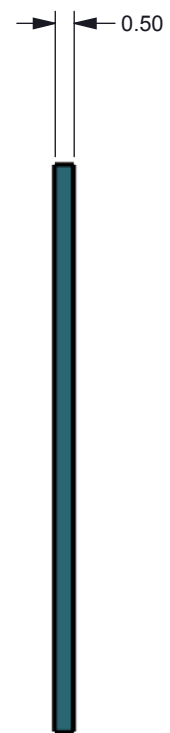
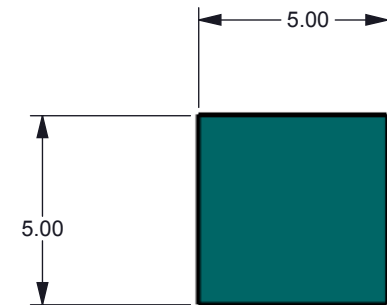
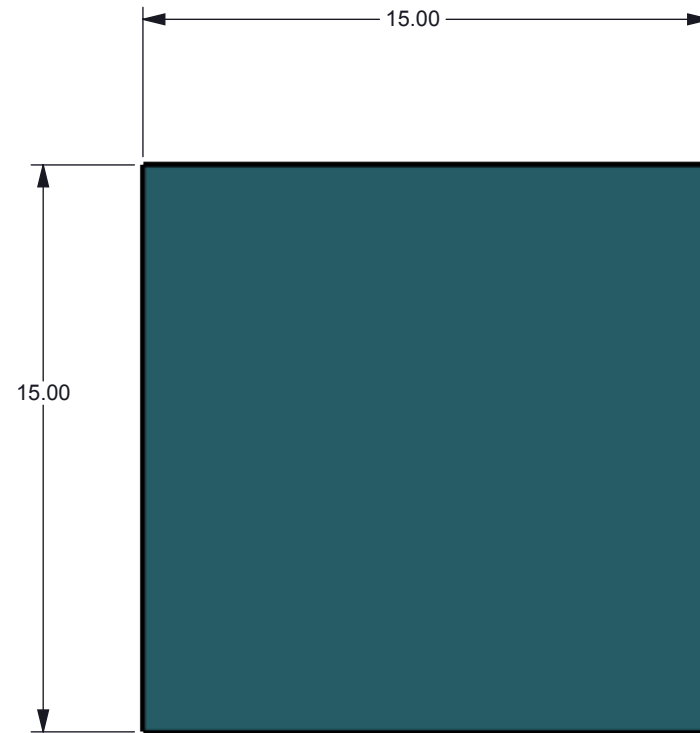
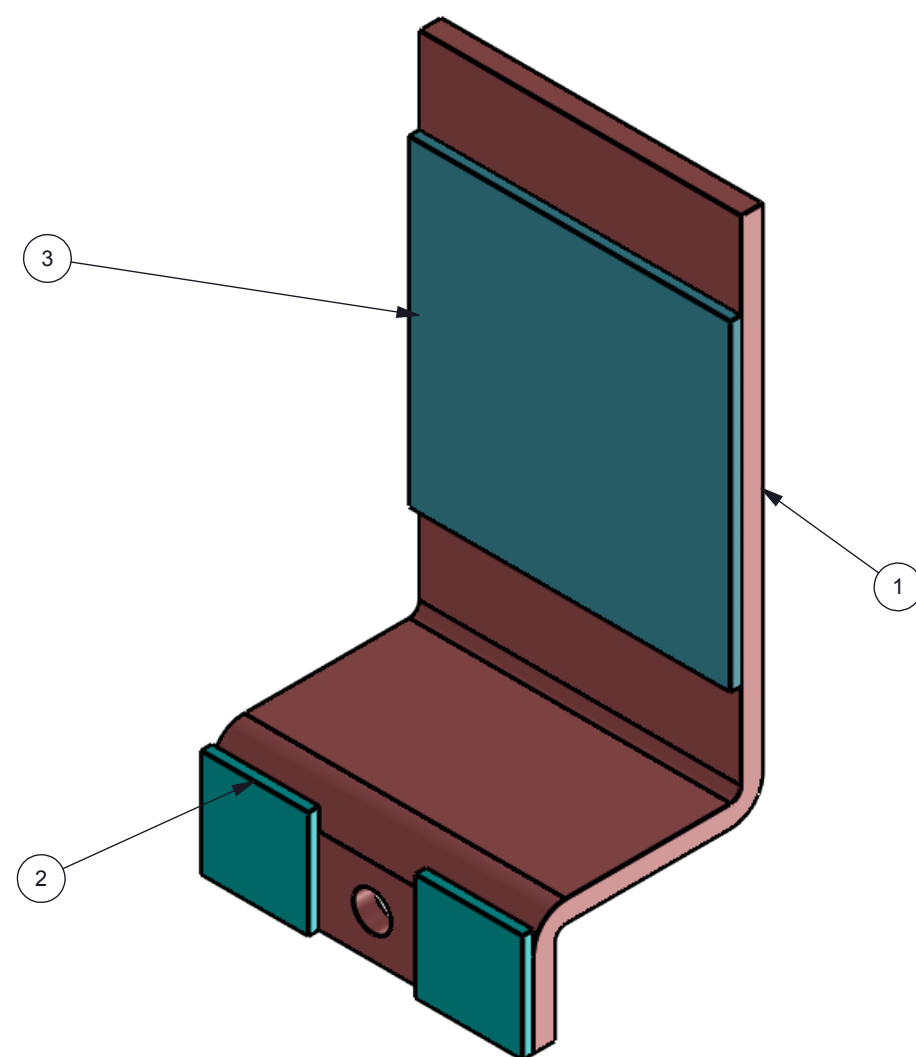

ITEM NO.	PART NUMBER	DESCRIPTION	QTY.
1	P2NHD LED HEATSINK	HEATSINK	1
2	P2NHD THERMAL PAD 2	THERMAL PAD (1168-1450-ND - DIGIKEY)	2
3	P2NHD THERMAL PAD 1	THERMAL PAD (TG2030-15-15-0.5-ND - DIGIKEY)	1

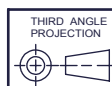

UNLESS OTHERWISE SPECIFIED		DWN STEVE SMITH	DATE 9/13/2016	 TEXAS INSTRUMENTS HEATSINK ASSEMBLY	
<ul style="list-style-type: none"> DIMENSIONS ARE IN MILLIMETERS TOLERANCES: ANGLES ±1° 2 PLACE DECIMALS ±0.25 1 PLACE DECIMALS ±0.50 DIMENSIONAL LIMITS APPLY BEFORE PROCESSES INTERPRET DIMENSIONS IN ACCORDANCE WITH ASME Y14.5M-1994 REMOVE ALL BURRS AND SHARP EDGES PARENTHETICAL INFO FOR REF ONLY 		Engr			
NEXT ASSY		CQE/QA		CM	SCALE 2:1
USED ON		Apprvd		SIZE B	REV B
APPLICATION				SHEET 1 OF 1	

IMPORTANT NOTICE FOR TI DESIGN INFORMATION AND RESOURCES

Texas Instruments Incorporated ("TI") technical, application or other design advice, services or information, including, but not limited to, reference designs and materials relating to evaluation modules, (collectively, "TI Resources") are intended to assist designers who are developing applications that incorporate TI products; by downloading, accessing or using any particular TI Resource in any way, you (individually or, if you are acting on behalf of a company, your company) agree to use it solely for this purpose and subject to the terms of this Notice.

TI's provision of TI Resources does not expand or otherwise alter TI's applicable published warranties or warranty disclaimers for TI products, and no additional obligations or liabilities arise from TI providing such TI Resources. TI reserves the right to make corrections, enhancements, improvements and other changes to its TI Resources.

You understand and agree that you remain responsible for using your independent analysis, evaluation and judgment in designing your applications and that you have full and exclusive responsibility to assure the safety of your applications and compliance of your applications (and of all TI products used in or for your applications) with all applicable regulations, laws and other applicable requirements. You represent that, with respect to your applications, you have all the necessary expertise to create and implement safeguards that (1) anticipate dangerous consequences of failures, (2) monitor failures and their consequences, and (3) lessen the likelihood of failures that might cause harm and take appropriate actions. You agree that prior to using or distributing any applications that include TI products, you will thoroughly test such applications and the functionality of such TI products as used in such applications. TI has not conducted any testing other than that specifically described in the published documentation for a particular TI Resource.

You are authorized to use, copy and modify any individual TI Resource only in connection with the development of applications that include the TI product(s) identified in such TI Resource. NO OTHER LICENSE, EXPRESS OR IMPLIED, BY ESTOPPEL OR OTHERWISE TO ANY OTHER TI INTELLECTUAL PROPERTY RIGHT, AND NO LICENSE TO ANY TECHNOLOGY OR INTELLECTUAL PROPERTY RIGHT OF TI OR ANY THIRD PARTY IS GRANTED HEREIN, including but not limited to any patent right, copyright, mask work right, or other intellectual property right relating to any combination, machine, or process in which TI products or services are used. Information regarding or referencing third-party products or services does not constitute a license to use such products or services, or a warranty or endorsement thereof. Use of TI Resources may require a license from a third party under the patents or other intellectual property of the third party, or a license from TI under the patents or other intellectual property of TI.

TI RESOURCES ARE PROVIDED "AS IS" AND WITH ALL FAULTS. TI DISCLAIMS ALL OTHER WARRANTIES OR REPRESENTATIONS, EXPRESS OR IMPLIED, REGARDING TI RESOURCES OR USE THEREOF, INCLUDING BUT NOT LIMITED TO ACCURACY OR COMPLETENESS, TITLE, ANY EPIDEMIC FAILURE WARRANTY AND ANY IMPLIED WARRANTIES OF MERCHANTABILITY, FITNESS FOR A PARTICULAR PURPOSE, AND NON-INFRINGEMENT OF ANY THIRD PARTY INTELLECTUAL PROPERTY RIGHTS.

TI SHALL NOT BE LIABLE FOR AND SHALL NOT DEFEND OR INDEMNIFY YOU AGAINST ANY CLAIM, INCLUDING BUT NOT LIMITED TO ANY INFRINGEMENT CLAIM THAT RELATES TO OR IS BASED ON ANY COMBINATION OF PRODUCTS EVEN IF DESCRIBED IN TI RESOURCES OR OTHERWISE. IN NO EVENT SHALL TI BE LIABLE FOR ANY ACTUAL, DIRECT, SPECIAL, COLLATERAL, INDIRECT, PUNITIVE, INCIDENTAL, CONSEQUENTIAL OR EXEMPLARY DAMAGES IN CONNECTION WITH OR ARISING OUT OF TI RESOURCES OR USE THEREOF, AND REGARDLESS OF WHETHER TI HAS BEEN ADVISED OF THE POSSIBILITY OF SUCH DAMAGES.

You agree to fully indemnify TI and its representatives against any damages, costs, losses, and/or liabilities arising out of your non-compliance with the terms and provisions of this Notice.

This Notice applies to TI Resources. Additional terms apply to the use and purchase of certain types of materials, TI products and services. These include; without limitation, TI's standard terms for semiconductor products (<http://www.ti.com/sc/docs/stdterms.htm>), [evaluation modules](#), and [samples](http://www.ti.com/sc/docs/sampterm.htm) (<http://www.ti.com/sc/docs/sampterm.htm>).

Mailing Address: Texas Instruments, Post Office Box 655303, Dallas, Texas 75265
Copyright © 2017, Texas Instruments Incorporated