

ZZ3 ■ These assemblies must comply with workmanship standards IPC-A-610 Class 2, unless otherwise specified.

ZZ2 ■ These assemblies must be clean and free from flux and all contaminants. Use of no clean flux is not acceptable.

ZZ1 ■ These assemblies are ESD sensitive, ESD precautions shall be observed.

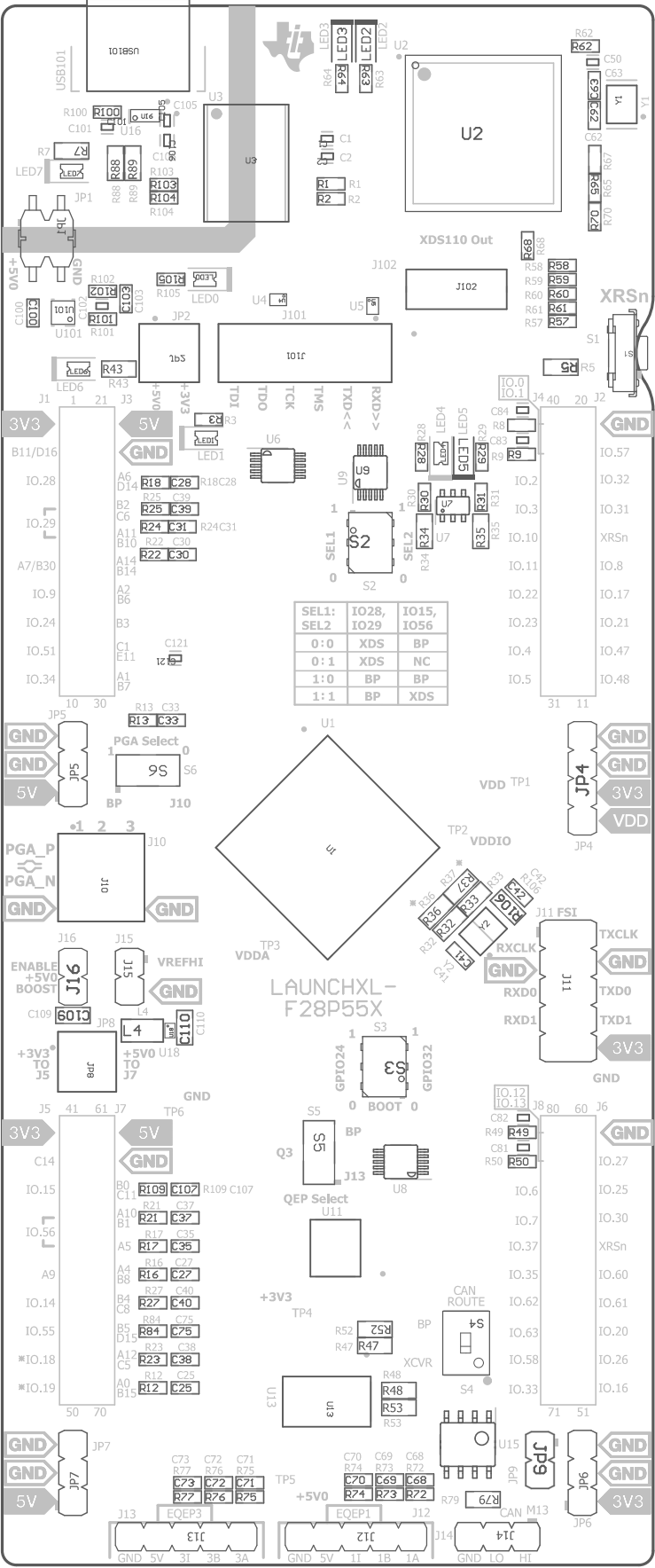

COMPONENTS MARKED 'DNP' SHOULD NOT BE POPULATED.
ASSEMBLY VARIANT: [No Variations]

PCB VIEWED FROM TOP SIDE	BOARD #: MCU133	REV: A	SUN REV: Unknown revision
M5pAssembly Top	TID #: N/A		
PLOT NAME = TopAssembly Drawing	GENERATED : 4/5/2024	7:10:28 PM	TEXAS INSTRUMENTS

